

Kentucky Horse Park Pedway Project

Lexington, Kentucky

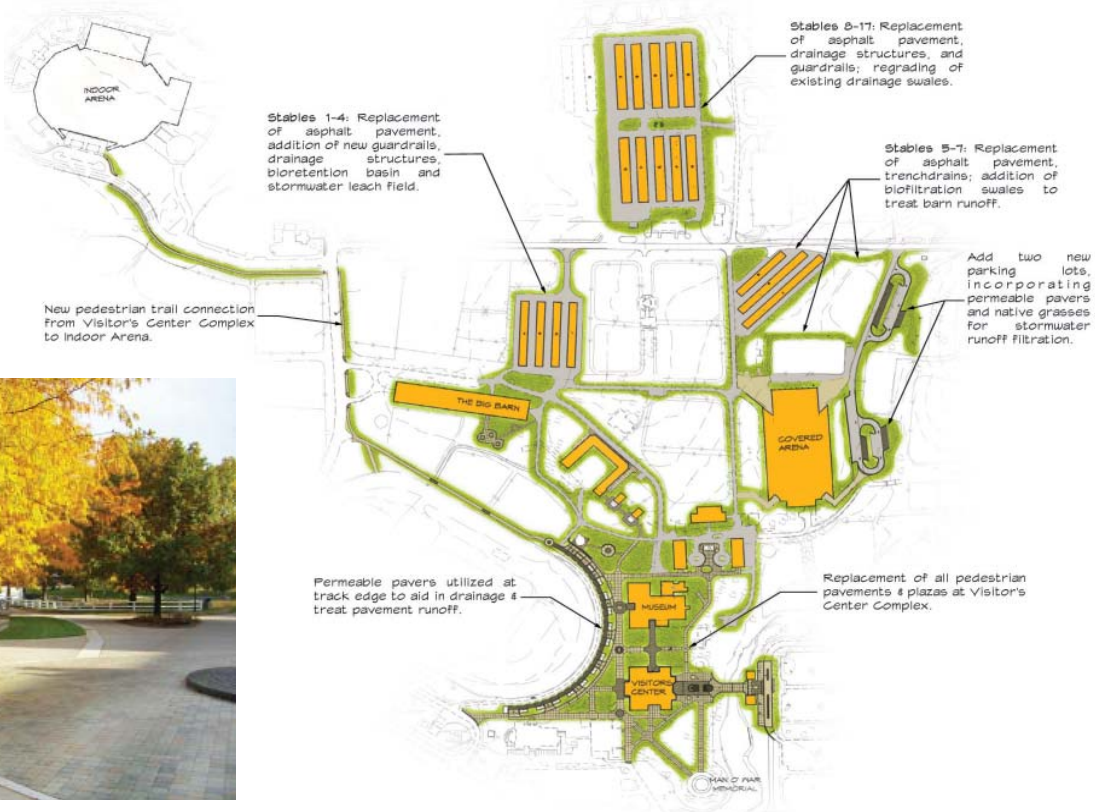

Client:
 Commonwealth of Kentucky,
 Division of Engineering and
 Contract Administration and
 The Kentucky Horse Park

Client Contact:
 Butch Hatcher, DECA,
 502.564.3155
 Lindsey Flora, KHP,
 859.259.4299

Project Completed:
 November 2009

Cost:
 \$3.5 Million

Project Team:
 Morgan McIlwain, RLA, ASLA
 Ramona Fry, RLA, ASLA,
 LEED AP

Project Description:

M2D Design Group served as the prime consultant for a large pavement redesign and replacement project at the Kentucky Horse Park, on preparation for the 2010 World Equestrian Games. As prime consultant, M2D provided analysis of existing site and pavement conditions worked with the Division of Engineering and Contract Administration and the Horse Park to determine pavement renovation. As part of the project, M2D designed new pedestrian and vehicular pavement design for the Visitor's Center Complex, stables, covered arena, existing drives, and two new parking lots.

M2D utilized several pavement types, including asphalt, exposed aggregate concrete pavement, and pavers. In addition, permeable paver systems were designed for several areas with existing drainage problems and in the new parking lots to help treat parking runoff. Design services included all design phases, from analysis and schematic design, construction documents, cost estimating and contract administration. The project design was fast tracked, completed and bid in less than four months and came in under estimated cost.

