

Murray State University Residential Master Plan

Murray, Kentucky

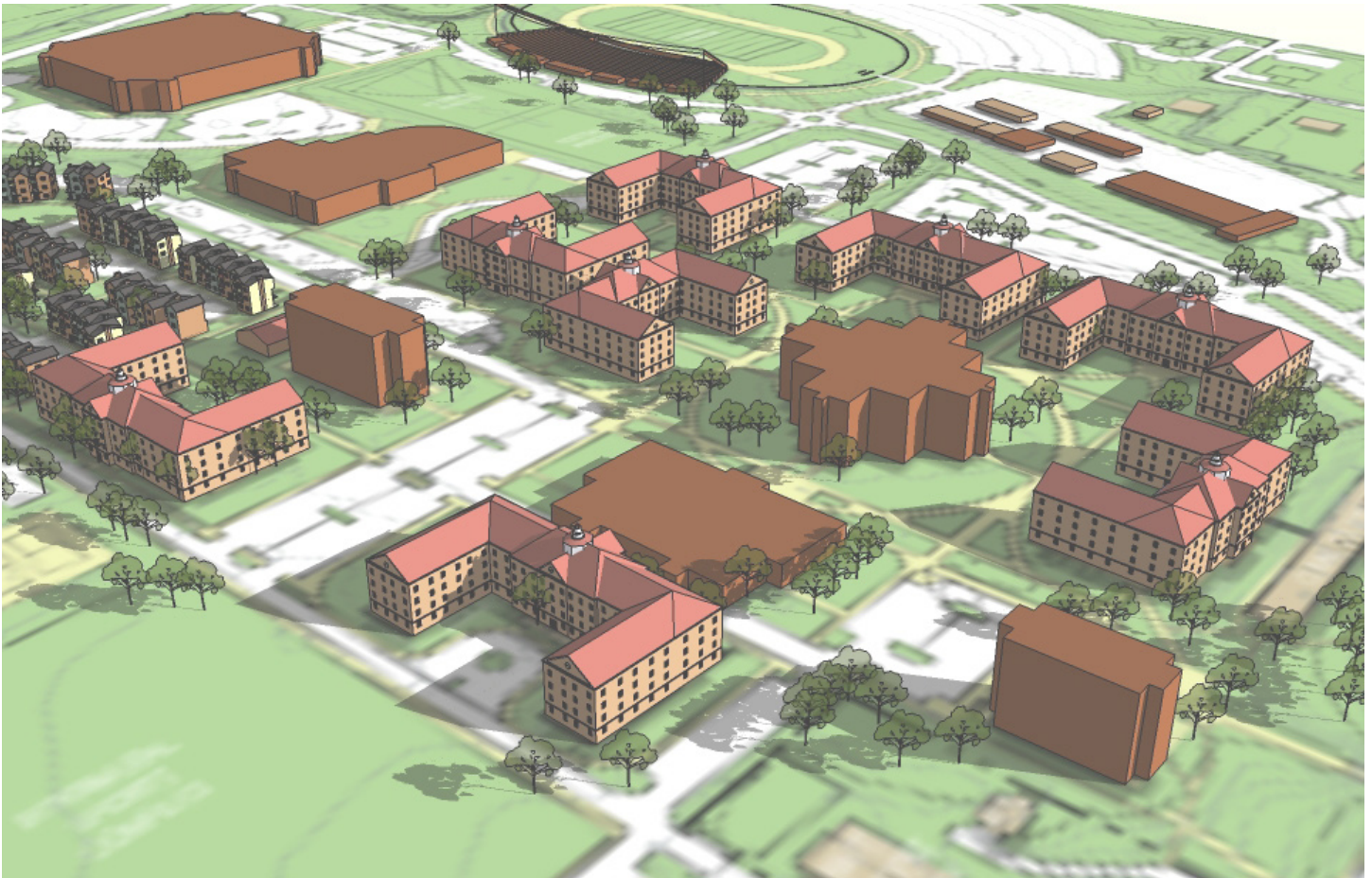

The Interactive Three Dimensional Model For The Murray Campus Will Help Us Site Future Buildings And Outdoor Spaces.

Client: Murray State University

*Client Contact: Kim Oatman, P.E.
Capital Construction:
1.270.762.3992*

Project Completion: June 2007

*Cost: 45,000.00
Master Plan Fee Only*

*Project Team:
Mark. C. Aronld, ASLA, RLA
Jocelyn Hirshaw, ASLA*

Project Description:

Mark Arnold and Jocelyn Hinshaw recently completed a Master Plan for the Murray State University Residential Campus. The plan involves review of the existing facilities and developing a variety of prototypical housing types in order to reduce the scale and enhance the neighborhood feel of the existing residential campus. We are taking a close look at trends in campus housing and looking for ways to integrate traditional dormitories, Junior and Senior level apartments with a greater degree of interior amenities, and a townhouse style development to enhance the sense of neighborhood as well as to transition the scale of the larger buildings to the surrounding community.

Part of the process involves helping Murray understand the Alternative Concepts in terms of building massing and scale of outdoor spaces. We are using state of the art software to develop three dimensional images for each of the alternatives allowing us to walk the design team through the proposals.